



Land Information Solutions

TRI STATE SURVEYING, LTD.

1925 E. Prater Way, Sparks, Nevada 89434

Telephone (775) 358-9491 ♦ FAX (775) 358-3664

Toll Free: 1-800-411-3752

July 10, 2014

Project No. 13124.010.RC

EXHIBIT A

ABANDONMENT VICTORIAN PLAZA CIRCLE

All that certain piece or parcel of land situate within a portion of the Northwest One-Half (N 1/2) of Section Eight (8), Township Nineteen (19) North, Range Twenty (20) East, Mount Diablo Meridian, City of Sparks, Washoe County, Nevada, being a portion of Victorian Plaza Circle as shown on Record of Survey Map No. 1186, filed in the Office of the Washoe County Recorder on June 23, 1978, and being more particularly described as follows:

BEGINNING at a point on the westerly right-of-way line of said Victorian Plaza Circle, from which the Northeast Corner of said Section 8 bears North 80°45'19" West, 4042.90;

THENCE along said westerly right-of-way line, North 00°52'45" East, 1.36;

THENCE leaving said westerly right-of-way line, South 44°08'35" West, 0.96 feet;

THENCE South 45°51'25" West, 0.96 Feet, to the Point of Beginning for this description;

CONTAINING an area of 0.46 square feet of land, more or less.

BASIS OF BEARINGS:

The basis of bearing for this description is the grid bearing of North 87°02'39" East between City of Sparks GPS control points 2057 and 2010 using NAD 83/94, Nevada State Plane West Zone, as shown on that "Record of Survey for the City of Sparks 2000 Geodetic Control Network" and recorded as Record of Survey Map No. 3385, File No. 2522263 on February 7, 2001, in Official Records of the County Recorder, Washoe County, Nevada. Grid to Ground Factor = 1.000197939.

Prepared by:

TRI STATE SURVEYING, LTD.

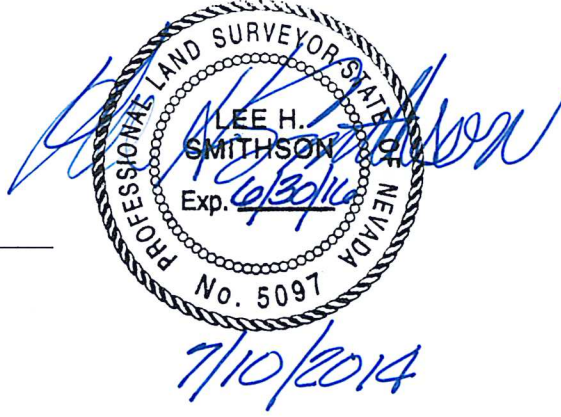

Lee H. Smithson, P.L.S.
Nevada Certificate No. 5097

EXHIBIT "B"



**NUGGET
SOUTHEAST
TOWER**
N.T.S.
A.P.N. 032-201-21

T. 19N., R. 20E.
M.D.M



S80°45'19"E 4042.90'
TIE TO SECTION CORNER

N53SM01111 (S2001)
N 14870502.15 (GROUND)
E 2290069.66

N00°52'45"E
1.36'

RIGHT-OF-WAY LINE

S54°08'35"E
0.96'
N45°51'25"E
0.96'

AREA=0.46 SQ.FT. +/-

N 14869852.47
E 2294060.01
(GROUND)

VICTORIAN PLAZA CIR.

EXISTING
BUILDING
LINE

0.40'-BUILDING
ECROACHMENT

BASIS OF BEARINGS

THE GRID BEARING OF S89°24'34"E, BETWEEN CITY OF SPARKS GPS CONTROL POINTS 2001 (N53SM01111) & 2064 (N53SM01114) USING NAD 83/94-HARN, AS SHOWN ON THAT "RECORD OF SURVEY FOR THE CITY OF SPARKS 2000 GEODETIC CONTROL NETWORK" RECORDED AS RECORD OF SURVEY MAP 3885, FILE NO. 2522263, FEBRUARY 7, 2001, OFFICIAL RECORDS OF WASHOE COUNTY, NEVADA.
GRID TO GROUND FACTOR = 1.000197939

 TRI STATE SURVEYING, LTD
1925 E. PRATER WAY
SPARKS, NEVADA 89434
(775) 358-9491 FAX 358-3664

EXHIBIT MAP
TO ACCOMPANY
LEGAL DESCRIPTION
OF ABANDONMENT

JOB NO.
13124.01RC

SHEET
1
OF 1

DRAWN BY LHS
CHECKED BY DCC DATE 07-31-2014

SPARKS

NEVADA